

8 POLES—750 RPM

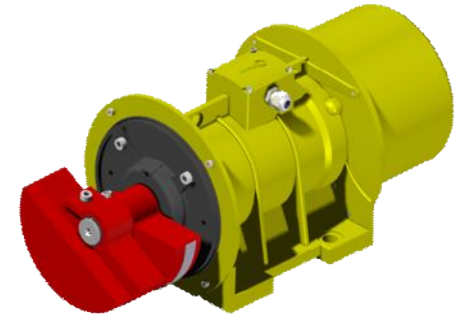

MECHANICAL DATA					ELECTRICAL DATA			
RPM	TYPE	Centrifugal Force		Static Moment	Weight	Nominal Voltage	Max Current	Max Input Power
(50 Hz)		KG	N	kgmm	KG	V	A	kw
750	VD 8-200	195	1913	303	28.0	230/400	1.38/0.80	0.43
	VD 8-300	290	2845	446	33.0	230/400	1.55/0.90	0.43
	VE 8-520	510	5003	848	64.5	230/400	2.68/1.55	0.50
	VE 8-780	765	7505	1205	73.0	230/400	2.77/1.60	0.55
	VG 8-1000	1000	9810	1483	92.0	230/400	3.98/2.30	0.95
	VG 8-1200	1200	11772	1956	99.0	230/400	4.67/2.70	1.10
	VH 8-1500	1500	14715	2402	119.0	230/400	6.92/4.00	1.50

Fig.1

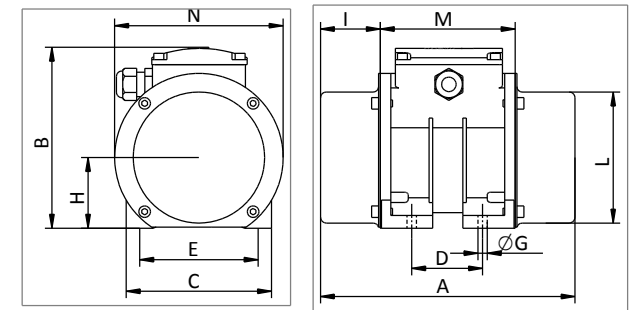

DIMENSIONS (mm)													
TYPE	A	B	C	D	E	ØGx4	H	I	L	M	N	Cable Entry	Fig. No
VD 8-200	368	235	210	120	170	17	109	89	188	190	230	M20 x 1.5	2
VD 8-300	416	235	210	120	170	17	109	113	188	190	230	M20 x 1.5	2
VE 8-520	520	253	235	140	190	17	116	131	212	259	274	M20 x 1.5	2
VE 8-780	578	253	235	140	190	17	116	160	212	259	274	M20 x 1.5	2
VG 8-1000	628	277	270	155	225	22	130	169	234	290	294	M20 x 1.5	2
VG 8-1200	628	277	270	155	225	22	130	169	234	290	294	M20 x 1.5	2
VH 8-1500	604	335	310	155	255	23.5	160	147	290	310	333	M25 X 1.5	2

Fig.2

