



## FP90 PUMP

### Applications:

- Cutting, turning, milling, boring, grinding and similar applications of the machine tools,
- Cooling systems,
- Circulation systems. FP90 Pumps are used for pumping of cutting / cooling fluids.
- Pump has a peripheral impeller so it is recommended to use filtered fluid applications.

### Fluid Specifications:

- Coolants,
- Cutting oils,
- Fluid temperature 0...80 °C
- Kinematic viscosity 1...90 mm<sup>2</sup>/s

### Materials:

Pump body	: Cast iron - DIN GG 25
Volute	: Cast iron - DIN GG 25
Impeller	: Brass
Pump shaft	: Engineering steel - AISI 1040 (DIN C35) Stainless steel- AISI 420(DIN X20Cr13) (Optional)
Electric motor	: 3 phase induction motor - 2 pole, Protection degree IP 55

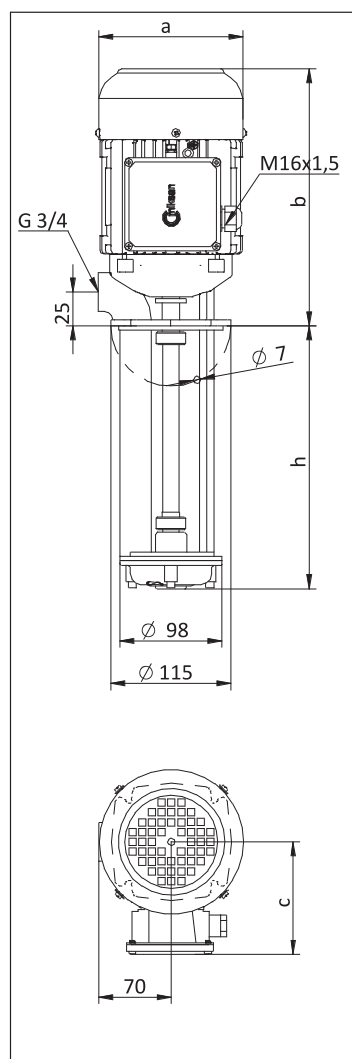

## DIMENSIONS & NOMINAL VALUES

TYPE	Depth of immersion				Weight	Power	Voltage	Frequency	Rated current	Speed
	h (mm)	a	b	c	kg	kW	V(Δ/Y)	Hz	A	rpm
		mm								
FP 90/11	110	138	240	111	10.6	1.1	230/400	50	4.85/2.8	2720
FP 90/15	150				10.9					
FP 90/20	200				11.2					
FP 90/25	250				11.5					
FP 90/30	300				11.8					

\* Pump dimensions according to EN 12157.

\*\* The performance curves are based on 1 mm<sup>2</sup>/s (cSt) kinematic viscosity values and 997 kg/m<sup>3</sup> density

\*\*\* Curve tolerance according to ISO 9906:2012 Grade 3B.

\*\*\*\* FP 90 pump has IE2 motor. According to IEC 60034-30-1:2014 standard this pump is excluded from efficiency class since its motor is completely integrated into the pump.

Performance Curve

